



GOLD MEDAL® PRODUCTS CO.

Lil' Maxx

Model No. 2389

Specifications

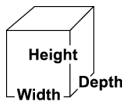
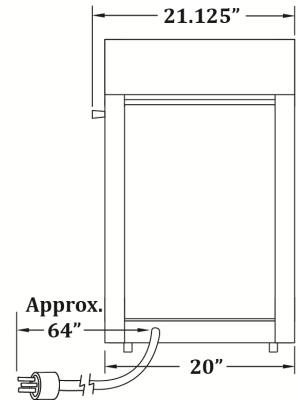
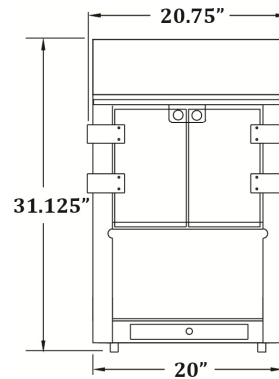

Overall Dimensions:

Width: 20.75"
Depth: 21.125"
Height: 31.125"

Features:

- 8 oz. Stainless Kettle
- Ideal Cart 2148CR (sold separately)
- Spacer 13318 (sold separately)

Electrical - Domestic

120V
1250 WATTS 60 Hz
(NEMA 5-15P) Plug

Plug Type:



NEMA 5-15P

Agency Approvals:



LISTED



NSF



Gold Medal Products Co.
10700 Medallion Drive, Cincinnati, OH 45241
Ph: (513) 769-7676, (800) 543-0862; Fax: (513) 769-8500
gmpopcorn.com info@gmpopcorn.com

Warranty shall be limited to the repair or replacement of any defective part for a period of six (6) months from the date of sale to the original purchaser with regard to labor and two (2) years with regard to parts and does not cover damage to the equipment caused by accident, alteration, improper use, voltage, abuse, or failure to follow instructions. See official warranty for complete details.